

---

# A28 D87 Brodsworth Quarry

## Site information

**Site name:** Brodsworth Quarry

**Site key:** D87

**Grid reference:** [SE 530 070] (accurate)

**Site type:** Disused quarry

**Local authority:** Doncaster Metropolitan Borough Council, South Yorkshire

**Site dimensions:** 200 x 200 x 3 m

**Site owner:** Mineral Investments

**Conservation status:** Regionally Important Geological

**Site date:** 16/9/97

**Field surveyor:** Scott Engering Date: 16/2/07

## Stratigraphy and rock types

**Time unit:** Permian **Rock unit:** Brotherton Formation, Zechstein Group

**Rock type:** Dolostone **Details:**

## Site map

(Figure 132) — D87 Brodsworth Quarry

This map is based upon Ordnance Survey topographic material with the permission of Ordnance Survey on behalf of The Controller of Her Majesty's Stationery Office, © Crown copyright. Unauthorised reproduction infringes Crown Copyright and may lead to prosecution or civil proceedings. Licence Number: 100017897 [2007]

## Site description

Site misidentified from the 1997 RIGS Survey. The area forms part of the large scale restoration of the area around Brodsworth Quarry and was not identified as a RIGS in 1997. The area was investigated but there was no ready access to the site. From a distance, old quarried faces were visible but these appeared to be landscaped and were not considered worthy of further investigation.

## Geodiversity value

None. Rating: 0

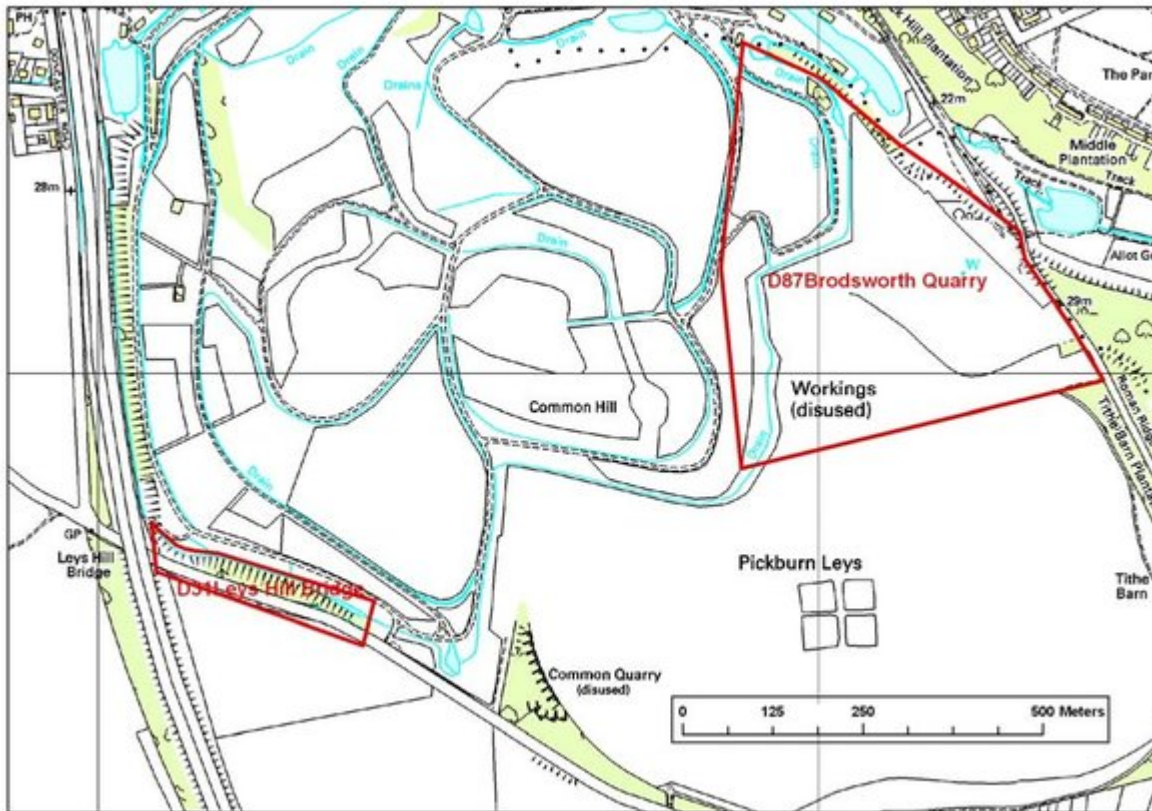

(Figure 132) D87 Brodsworth Quarry. This map is based upon Ordnance Survey topographic material with the permission of Ordnance Survey on behalf of The Controller of Her Majesty's Stationery Office, © Crown copyright. Unauthorised reproduction infringes Crown Copyright and may lead to prosecution or civil proceedings. Licence Number: 100017897 [2007].